

Manual

# Automatic Pump Control

For pumps up to  
1 118 W

**1.5 HP**

Applies for:

Code	Model
102417	CPB-180

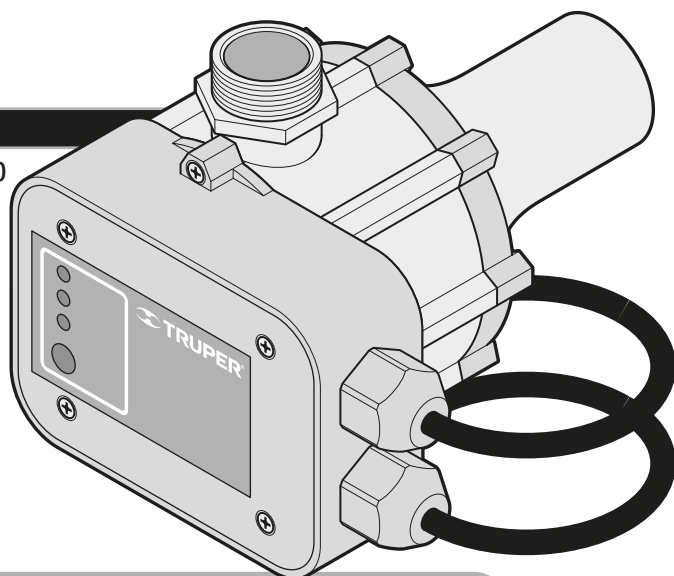

## CPB-180



 **CAUTION**



Read this manual thoroughly  
before using the tool.





Especificaciones técnicas .....	<b>3</b>
Power requirements .....	<b>3</b>
 General power tool safety warnings .....	<b>4</b>
 Safety Warnings for water pressurizers .....	<b>5</b>
Parts .....	<b>5</b>
Wiring .....	<b>6</b>
Installation .....	<b>6</b>
Start Up .....	<b>7</b>
Maintenance .....	<b>8</b>
Troubleshooting .....	<b>9</b>
Notes .....	<b>10</b>
Authorized Service Centers .....	<b>11</b>
Warranty policy .....	<b>12</b>

## **CAUTION**

To gain the best performance of the tool, prolong the duty life, make the Warranty valid if necessary, and to avoid hazards of fatal injuries please read and understand this Manual before using the tool.

Keep this manual for future references.

The illustrations in this manual are for reference only. They might be different from the real tool.

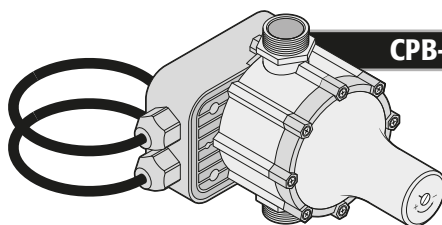

**CPB-180**



# Technical data



## CPB-180

Code	102417
Description	Automatic pump control
Voltage	127 V ~
Frequency	60 Hz
Current	16 A
For pumps up to	1 118 W (1.5Hp)
Input and output diameter	1"
Working pressure	de 1.75 bar (25 PSI) a 3.5 bar (51 PSI)
Maximum operating pressure	10 bar (145 PSI)
Water maximum temperature	140 °F
Conductors	18 AWG x 3C with insulation temperature of 221 °F
Work cycle	50 min of work and 20 min of rest. Maximum 6 hours per day.
Insulation	Class I

The power cable has cable clamps type: Y  
The construction class of the tool is: Basic insulation.  
The thermal insulation class of the motor wiring is: Class B

**⚠ WARNING** Avoid the risk of electric shock or severe injury. When the power cable gets damaged it should only be replaced by the manufacturer or at a **TRUPER** Authorized Service Center. The build quality of the electric insulation is altered if spills or liquid gets into the tool while in use. Do not expose to rain, liquids and/or dampness.

**⚠ WARNING** Before gaining access to the terminals all power sources should be disconnected.



## Power requirements

**⚠ CAUTION** Connection to the power supply must be made by an electrical professional, following the electrical diagram on the right.

**⚠ CAUTION** Use a separate electrical circuit for the pump. This circuit must not have conductors with a gauge smaller than 12 AWG, and must be protected with a 20 A time delay fuse. Before connecting the motor to the power line, make sure that the voltage is equal to the voltage indicated on the motor nameplate. Operating at a lower voltage will damage the motor.

**⚠ CAUTION** The power cords are color-coded as follows:

Green: Ground  
White: Neutral  
Black: Line

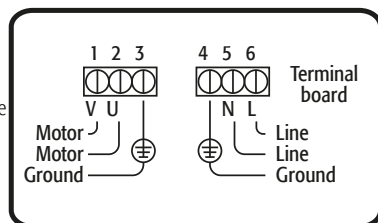

Ampere Capacity	Number of Conductors	Extension Gauge	
		From 6 ft to 49 ft	Higher than 49 ft
From 0 and up to 10 A	3 (one grounded)	18 AWG	16 AWG
From 10 and up to 13 A		16 AWG	14 AWG
From 13 and up to 15 A		14 AWG	12 AWG
From 15 and up to 20 A		8 AWG	6 AWG

**⚠ WARNING** When using power tools outdoors use **VOLTECK** grounded extension cable labeled "Outdoors Use". These extension cables are specially manufactured for outdoors use and reduce the risk of electric shock.







## General power tool safety warnings



**⚠ WARNING! Read carefully all safety warnings and instructions listed below.** Failure to comply with any of these warnings may result in electric shock, fire and / or severe damage. **Save all warnings and instructions for future references.**

### Work area

**Keep your work area clean, and well lit.**

Cluttered and dark areas may cause accidents.



**Never use the tool in explosive atmospheres, such as in the presence of flammable liquids, gases or dust.**

Sparks generated by power tools may ignite the flammable material.



**Keep children and bystanders at a safe distance while operating the tool.**

Distractions may cause losing control.



### Electrical Safety

**The tool plug must match the power outlet. Never modify the plug in any way. Do not use any adapter plugs with grounded power tools.**

Modified plugs and different power outlets increase the risk of electric shock.



**Avoid body contact with grounded surfaces, such as pipes, radiators, electric ranges and refrigerators.**

The risk of electric shock increases if your body is grounded.

**Do not expose the tool to rain or wet conditions.**

Water entering into the tool increases the risk of electric shock.

**Do not force the cord. Never use the cord to carry, lift or unplug the tool. Keep the cord away from heat, oil, sharp edges or moving parts.**

Damaged or entangled cords increase the risk of electric shock.

**When operating a tool outdoors, use an extension cord suitable for outdoor use.**

Using an adequate outdoor extension cord reduces the risk of electric shock.

**If operating the tool in a damp location cannot be avoided, use a ground fault circuit interrupter (GFCI) protected supply.**

Using a GFCI reduces the risk of electric shock.

### Personal safety

**Stay alert, watch what you are doing and use common sense when operating a tool. Do not use a power tool while you are tired or under the influence of drugs, alcohol or medication.**

A moment of distraction while operating the tool may result in personal injury.

**Use personal protective equipment. Always wear eye protection.**

Protective equipment such as safety glasses, anti-dust mask, non-skid shoes, hard hats and hearing protection used in the right conditions significantly reduce personal injury.



**Prevent unintentional starting up. Ensure the switch is in the "OFF" position before connecting into the power source and / or battery as well as when carrying the tool.**

Transporting power tools with the finger on the switch or connecting power tools with the switch in the "ON" position may cause accidents.

**Remove any wrench or vice before turning the power tool on.**

Wrenches or vices left attached to rotating parts of the tool may result in personal injury.

**Do not overreach. Keep proper footing and balance at all times.**

This enables a better control on the tool during unexpected situations.

**Dress properly. Do not wear loose clothing or jewelry. Keep hair, clothes and gloves away from the moving parts.**

Loose clothes or long hair may get caught in moving parts.



**If you have dust extraction and recollection devices connected onto the tool, inspect their connections and use them correctly.**

Using these devices reduce dust-related risks.

### Power Tools Use and Care

**Do not force the tool. Use the adequate tool for your application.**

The correct tool delivers a better and safer job at the rate for which it was designed.



**Do not use the tool if the switch is not working properly.**

Any power tool that cannot be turned ON or OFF is dangerous and should be repaired before operating.

**Disconnect the tool from the power source and / or battery before making any adjustments, changing accessories or storing.**

These measures reduce the risk of accidentally starting the tool.

**Store tools out of the reach of children. Do not allow persons that are not familiar with the tool or its instructions to operate the tool.**

Power tools are dangerous in the hands of untrained users.



**Service the tool. Check the mobile parts are not misaligned or stuck. There should not be broken parts or other conditions that may affect its operation. Repair any damage before using the tool.**

Most accidents are caused due to poor maintenance to the tools.

**Keep the cutting accessories sharp and clean.**

Cutting accessories in good working conditions are less likely to bind and are easier to control.



**Use the tool, components and accessories in accordance with these instructions and the projected way to use it for the type of tool when in adequate working conditions.**

Using the tool for applications different from those it was designed for, could result in a hazardous situation.

### Service

**Repair the tool in a TRUPER Authorized Service Center using only identical spare parts.**

This will ensure that the safety of the power tool is maintained.



# Safety warnings for the use of water pressurizers



## Suitable uses

- The device complies with the most current safety requirements as long as it is used for its intended purpose. The device may only be used under permissible performance restrictions.
- It must not be used for pumping drinking water or for watering foodstuffs. Explosives, combustible or aggressive materials, substances harmful to health or sewage must not be pumped.
- The device is not suitable for commercial or industrial use.
- Improper use or modifications to the device, the use of components that have not been tested and approved by the manufacturer, may result in unforeseen damage to the device and the operator, and relieves the manufacturer of its legal liability.
- The automatic pump control is used to command a water pump to start and stop when any tap or valve in the system is opened or closed. The control will maintain a constant pressure and flow of water in the system whenever any mains water outlet is open during pump operation.

**⚠ WARNING** The control can be used for either potable or non-potable water. In installations where both types of fluid are present, ensure that potable water is not mixed with non-potable water.

**⚠ CAUTION** • Do not subject the device to rain. Do not use the device around wet areas.

**⚠ WARNING** • Do not use the device in areas where there is danger of explosion or near combustible liquids or gases.

**⚠ WARNING** • Do not direct the water jet at the device or other electrical components. There is a danger to life due to electric shock.

**⚠ CAUTION** • Ensure that the extension cord does not contact the water supplying the unit.

• Do not install or turn on the unit when people or animals are in or in contact with the water to be pumped (e.g., a pool).

• Do not leave the unit unattended. If it is to be left for an extended period of time, unplug it.

• Any repairs should only be made by a  **TRUPER** Authorized Service Center. Failure to do so exposes you to electric shock and invalidates the warranty.

• Symbols affixed to the device must not be removed or covered. Any information on the device that is no longer legible must be replaced immediately.

• Read and obey the operating instructions before pumping.

## Parts

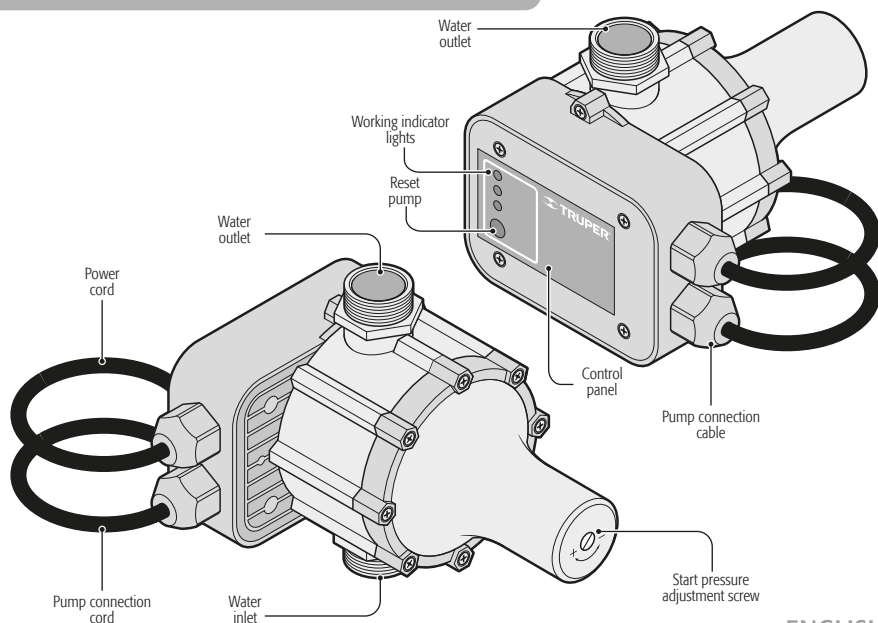



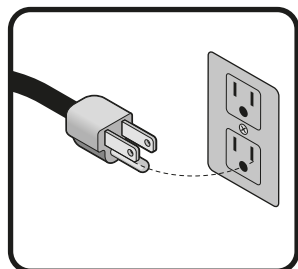

- For domestic use it is recommended to use a grounded polarized plug for pump operation.

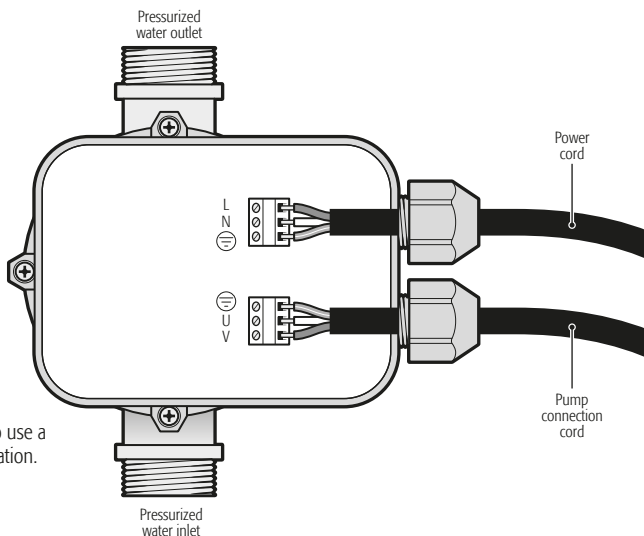

## Installation

### Automatic control coupling

- Attach the automatic control (A) to the pump outlet with a coupling nut (B) and hand tighten. Check that the arrows (C) point in the direction of the outlet line.
- Turn the automatic control to the required position and tighten the coupling nut.
- Connect the outlet of the automatic control to the pressure line (outlet) by means of a flexible hose (D).
- Connect the automatic control to the pump and then to the outlet (E).

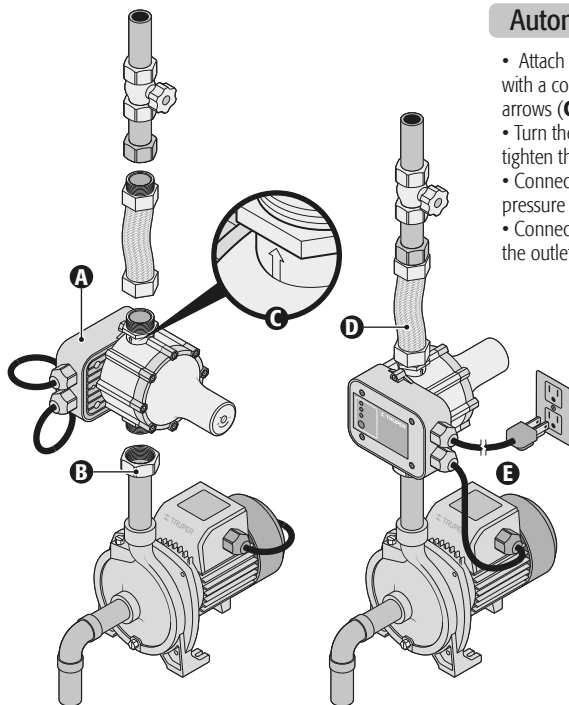



## Line connection

- The suction and pressure lines should be installed in such a way that they do not exert any mechanical force or stress on the pump or the automatic control.
- Both lines must be perfectly sealed. Leaks cause air to accumulate in the piping and prevent or reduce water output. Avoid bends and slopes as much as possible to prevent the formation of air bubbles that can affect the efficiency of the pressurizer. All connections should be sealed with hemp and thick paste (for metal threads) or Teflon sealing tape (for synthetic threads).
- All line components should be installed by a professional.

## Suction line connection (inlet)

- If the liquid is contaminated, a suction strainer (**A**) should be used to protect the pump from sand and dirt.
- It is recommended to use a check valve (**B**) so that the suction line is not emptied when the pump is switched off.
- The line pipe should have an internal diameter of at least 1". It should be bend resistant and suitable for vacuum use.
- The line should be as short as possible, as the pumping capacity decreases with increasing line length.
- The line should rise regularly towards the pump. To prevent air pockets.
- It should be ensured that there is sufficient water and the end of the line should always be in the water.

## Automatic control height

- The height of the line between the automatic control and the pump (**D**) must be matched to the height of the pressure line outlets.
- If the water column between the pump and the highest tap exceeds 49 ft, the automatic control cannot be installed directly above the pump, but must be raised until the water column between the automatic control and the highest tap does not exceed 49 ft, i.e. if the water column is 65 ft from the pump, the automatic control must be placed at a distance of 16 ft above the pump.

## Pressure line connection (outlet)

- It is recommended to use a gate or globe valve (**C**) to facilitate maintenance operations of the automatic control.
- The piping of the line should be fixed so that when there are vibrations, stress and weight do not affect the pressurizer.

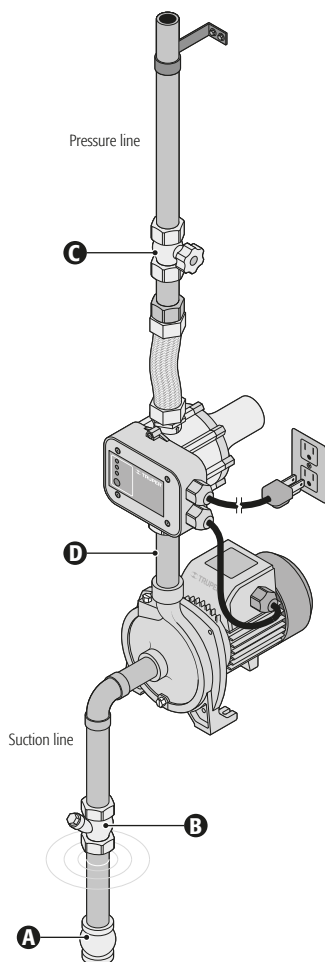

# Start up

## Draining the pump

- ⚠ WARNING** • The pump must be filled with clean water before start-up and during operation, otherwise it will suffer irreparable damage not covered by the warranty.
- After a new connection and before each start-up check for water leakage or air ingress in both the pump and suction line, making sure that the pump is primed.
  - To obtain better suction, the use of a suction filter is recommended.



- After installation is complete, connect the pressure control to the power supply. The green "On" light on the control panel illuminates to indicate that the control is energized.
- The control automatically turns on the pump when water is needed. If the pressure line is open, the system pressure is reduced below the start pressure and the pump is energized. The yellow light on the control panel illuminates.
- When a line shutoff occurs, the water pressure slowly increases until the cut-in pressure is reached, shutting down the pump. The yellow "Pump On" light on the control panel also turns off.
- The control has a flow sensor which serves to protect the pump when the pump runs dry (no water in the inlet line) for more than 10 seconds. The red "Fault" light on the control panel will illuminate to indicate that there is a supply failure. In this case, check the water supply and installation. Press the red "Reset" button to restore control operation.

- The control is factory set to a start pressure of between 1.5 bar - 1.2 bar. This pressure can be adjusted by turning the screw located on the back of the control according to the needs of the system. It is recommended to adjust the screw when the line is open, this will reduce the pressure inside the control and make it easier to turn the screw. As a general rule, the start pressure should be 0.2 bar above the gauge head, while the pump to be used should be able to provide at least 0.8 bar above the set pressure

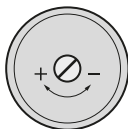

- The following table shows 2 examples of this rule for pump selection and control start pressure setting:

Height of use	Height for starting pressure	Maximum pump discharge pressure in m.c.a.
20 m (2 bar)	2.2 bar	31 m (3 bar)
25 m (2.5 bar)	2.7 bar	36 m (3.5 bar)

Note: 1 bar = 10.2 m.c.a.

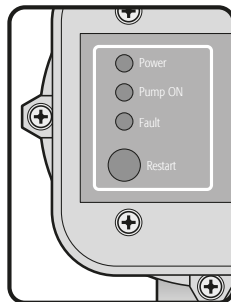

- The control has a thermal protection switch. The pressurizer stops if an overload condition occurs. The motor restarts automatically after the motor has cooled down.
- To avoid overheating refer to the troubleshooting section on page 9.
- The plug and connections must be protected against splashing water.

## Maintenance

### Cleaning and care

- Regularly inspect all mounting screws and make sure that they are tightened correctly. If any of the screws are loose, tighten them immediately.

### Filter cleaning

- The filter should be cleaned regularly, depending on the contamination of the water supply.





### Service

- Tool service should only be performed at a **TRUPER** Authorized Service Center. Service and maintenance by unqualified persons can be dangerous and may result in personal injury and invalidate the product warranty.

### Storage

- In case of danger of frost, disassemble the device and accessories, clean and store in a place protected from frost. Otherwise, the device may be damaged.
1. Switch off the device, disconnect the plug.
  2. Open the pressure line (open the faucet or nozzle), allow the water to drain completely.
  3. Drain the pump completely by unscrewing the drain plug.
  4. Disassemble the suction and pressure lines of the device.
  5. Store the device in a frost-free room (at least 41 °F).



Problem	Cause	Solution
Pump does not work.	<ul style="list-style-type: none"> <li>• No power.</li> <li>• Reverse wiring (pump-power supply).</li> <li>• Overheating. Water temperature is too high.</li> <li>• Motor overheating. Clogged ventilation slots.</li> <li>• Motor protection switch activated.</li> <li>• Defective motor.</li> </ul>	<ul style="list-style-type: none"> <li>• Check the cable, plug and fuse.</li> <li>• Correct wiring.</li> <li>• Avoid the cause of heating, wait for the water to cool down.</li> <li>• Clean and remove any obstructions from the ventilation slots.</li> <li>• Wait for the device to cool down. If the problem persists, contact a  <b>TRUPER®</b> Authorized Service Center.</li> <li>• Go to a  <b>TRUPER®</b> Authorized Service Center.</li> </ul>
The flow rate is low.	<ul style="list-style-type: none"> <li>• Water shortage.</li> </ul>	<ul style="list-style-type: none"> <li>• Make sure there is enough water supply.</li> </ul>
Not enough pressure.	<ul style="list-style-type: none"> <li>• Suction line leaks.</li> <li>• Pump exceeds suction level.</li> <li>• Dirty or blocked filter.</li> <li>• Check valve blocked.</li> <li>• Leakage between the motor and pump, faulty pump shaft seal.</li> <li>• Pump dirty or blocked.</li> <li>• Air in the pump or suction pipe.</li> <li>• Fault mode is activated.</li> <li>• Change in water (sand) conditions.</li> <li>• Buried suction line.</li> </ul>	<ul style="list-style-type: none"> <li>• Seal the suction line, repair leaks and tighten all connections.</li> <li>• Place the pump no more than 26 ft above the level of the water container.</li> <li>• Clean or replace the filter.</li> <li>• Clean or replace the valve.</li> <li>• Go to a  <b>TRUPER®</b> Authorized Service Center.</li> <li>• Flush the pump with clean water and remove any obstructions.</li> <li>• Fill the pump receptacle with water.</li> <li>• For suction lines with check valve, fill the suction line with water.</li> <li>• Verify that the pump pressure is at least 0.8 bar higher than the controller start pressure.</li> <li>• Check the container and water quality.</li> <li>• Shorten or clamp the suction line. Use a filter screen with check valve.</li> </ul>
Cannot turn off the pump.	<ul style="list-style-type: none"> <li>• Very high shear pressure.</li> <li>• Suction side not sealed.</li> </ul>	<ul style="list-style-type: none"> <li>• Go to a  <b>TRUPER®</b> Authorized Service Center.</li> </ul>
Pump turns on and off repeatedly.	<ul style="list-style-type: none"> <li>• Water leakage in the pressure line.</li> </ul>	<ul style="list-style-type: none"> <li>• Seal the pressure line, repair leaks, and tighten all connections.</li> </ul>

If problems persist despite performing the recommended corrective actions, contact a  **TRUPER®** Authorized Service Center.







In the event of any problem contacting a  **TRUPER** Authorized Service Center, please see our webpage [www.truper.com](http://www.truper.com) to get an updated list, or call our toll-free numbers 800 690-6990 or 800 018-7873 to get information about the nearest Service Center.

**AGUASCALIENTES** **DE TODO PARA LA CONSTRUCCIÓN**  
GRAL. BARRAGÁN #1201, COL. GREMIAL, C.P. 20030,  
AGUASCALIENTES, AGS. TEL.: 449 994 0537

**BAJA CALIFORNIA** **SUCURSAL TIJUANA**  
AV. LA ENCANTADA, LOTE #5, PARQUE INDUSTRIAL EL  
FLORIDO II, C.P. 22244, TIJUANA, B.C.  
TEL.: 664 969 5100

**BAJA CALIFORNIA SUR** **FIX FERRETERÍAS**  
FELIPE ANGELES ESQ. RUIZ CORTÉZ S/N, COL. PUEBLO  
NUEVO, C.P. 23670, CD. CONSTITUCIÓN, B.C.S.  
TEL.: 613 132 1115

**CAMPECHE** **TORNILLERÍA Y FERRETERÍA AAA**  
AV. ALVARO OBREGÓN #324, COL. ESPERANZA  
C.P. 24080 CAMPECHE, CAMP. TEL.: 981 815 2808

**CHIAPAS** **FIX FERRETERÍAS**  
AV. CENTRAL SUR #27, COL. CENTRO, C.P. 30700,  
TAPACHULA, CHIS. TEL.: 962 118 4083

**CHIHUAHUA** **SUCURSAL CHIHUAHUA**  
AV. SILVESTRE TERRAZAS #128-11, PARQUE INDUSTRIAL  
BAFAR, CARRETERA MEXICO CUAUHTÉMOC, C.P. 31415,  
CHIHUAHUA, CHIH. TEL.: 614 434 0052

**MEXICO CITY** **FIX FERRETERÍAS**  
EL MONSTRUO DE CORREGIDORA, CORREGIDORA # 22,  
COL. CENTRO, C.P. 06060, CUAUHTÉMOC, CDMX.  
TEL.: 55 5522 5031 / 5522 4861

**COAHUILA** **SUCURSAL TORREÓN**  
CALLE METAL MECÁNICA #280, PARQUE INDUSTRIAL  
ORIENTE, C.P. 27278, TORREÓN, COAH.  
TEL.: 871 209 68 23

**COLIMA** **BOMBAS Y MOTORES BYMTESA DE MANZANILLO**  
BLVD. MIGUEL DE LA MADRID #190, COL. 16 DE  
SEPTIEMBRE, C.P. 28239, MANZANILLO, COL.  
TEL.: 314 332 1986 / 332 8013

**DURANGO** **TORNILLOS ÁGUILA, S.A. DE C.V.**  
MAZURIO #200, COL. LUIS ECHEVERRÍA, DURANGO,  
DGO. TEL.: 618 817 1946 / 618 818 2844

**ESTADO DE MÉXICO** **SUCURSAL CENTRO JILOTEPEC**  
PARQUE INDUSTRIAL # 1, COL. PARQUE INDUSTRIAL  
JILOTEPEC, JILOTEPEC, EDO. DE MÉX. C.P. 54257  
TEL.: 761 782 9101 EXT. 5728 Y 5102

**GUANAJUATO** **CÍA. FERRETERA NUEVO MUNDO S.A. DE C.V.**  
AV. MÉXICO - JAPÓN #225, CD. INDUSTRIAL, C.P. 38010,  
CELAYA, GTO. TEL.: 461 617 7578 / 79 / 80 / 88

**GUERRERO** **CENTRO DE SERVICIO ECLIPSE**  
CALLE PRINCIPAL MZ.1 LT. 1, COL. SANTA FE, C.P. 39010,  
CHILPANCIÑO, GRO. TEL.: 747 478 5793

**HIDALGO** **FERREPRECIOS S.A. DE C.V.**  
LIBERTAD ORIENTE #304 LOCAL 30, INTERIOR DE PASAJE  
ROBLEDO, COL. CENTRO, C.P. 43600, TULANCINGO,  
HGO. TEL.: 775 753 6615 / 775 753 6616

**JALISCO** **SUCURSAL GUADALAJARA**  
AV. ADOLFO B. HORN # 6800, COL. SANTA CRUZ DEL  
VALLE, C.P.: 45655, TLAJOMULCO DE ZUÑIGA, JAL.  
TEL.: 33 3606 5285 AL 90

**MICHOACÁN** **FIX FERRETERÍAS**  
AV. PASEO DE LA REPÚBLICA #3140-A, COL.  
EX-HACIENDA DE LA HUERTA, C.P. 58050, MORELIA,  
MICH. TEL.: 443 334 6858

**MORELOS** **FIX FERRETERÍAS**  
CAPITÁN ANZURES #95, ESQ. JOSÉ PERDIZ, COL.  
CENTRO, C.P. 62740, CUAUTLA, MOR.  
TEL.: 735 352 8951

**NAYARIT** **HERRAMIENTAS DE TEPEC**  
MAZATLAN #117, COL. CENTRO, C.P. 63000, TEPEC, NAY.  
TEL.: 311 258 0540

**NUEVO LEÓN** **SUCURSAL MONTERREY**  
CARRETERA LAREDO #300, 1B MONTERREY PARKS,  
COLONIA PUERTA DE ANAHUAC, C.P. 66052, ESCOBEDO,  
NUEVO LEÓN, TEL.: 81 8352 8791 / 81 8352 8790

**OAXACA** **FIX FERRETERÍAS**  
AV. 20 DE NOVIEMBRE #910, COL. CENTRO, C.P. 68300,  
TUXTEPEC, OAX. TEL.: 287 106 3092

**PUEBLA** **SUCURSAL PUEBLA**  
AV. PERIFÉRICO #2-A, SAN LORENZO ALMECATLA,  
C.P. 72710, CUAUHTLACINGO, PUE.  
TEL.: 222 282 8282 / 84 / 85 / 86

**QUERÉTARO** **ARU HERRAMIENTAS S.A. DE C.V.**  
AV. PUERTO DE VERACRUZ #110, COL. RANCHO DE  
ENMEDIO, C.P. 76842, SAN JUAN DEL RÍO, QRO.  
TEL.: 427 268 4544

**QUINTANA ROO** **FIX FERRETERÍAS**  
CARRETERA FEDERAL MZ. 46 LT. 3 LOCAL 2, COL. EJIDAL,  
C.P. 77710 PLAYA DEL CARMEN, Q.R.  
TEL.: 984 267 3140

**SAN LUIS POTOSÍ** **FIX FERRETERÍAS**  
AV. UNIVERSIDAD #1850, COL. EL PASEO, C.P. 78320,  
SAN LUIS POTOSÍ, S.L.P. TEL.: 444 822 4341

**SINALOA** **SUCURSAL CULIACÁN**  
AV. JESÚS KUMATE SUR #4301, COL. HACIENDA DE LA  
MORA, C.P. 80143, CULIACÁN, SIN.  
TEL.: 667 173 9139 / 173 8400

**SONORA** **FIX FERRETERÍAS**  
CALLE 5 DE FEBRERO #517, SUR LT. 25 MZ. 10, COL.  
CENTRO, C.P. 85000, CD. OBREGÓN, SON.  
TEL.: 644 413 2392

**TABASCO** **SUCURSAL VILLAHERMOSA**  
CALLE HELIO LOTES 1, 2 Y 3 MZ. #1, COL. INDUSTRIAL,  
2A ETAPA, C.P. 86010, VILLAHERMOSA, TAB.  
TEL.: 993 353 7444

**TAMAULIPAS** **VM ORINGS Y REFACCIONES**  
CALLE ROSITA #527 ENTRE 20 DE NOVIEMBRE Y GRAL.  
RODRÍGUEZ, FRACC. REYNOSA, C.P. 88780, REYNOSA,  
TAMS. TEL.: 899 926 7552

**TLAXCALA** **SERVICIOS Y HERRAMIENTAS INDUSTRIALES**  
PABLO SIDAR #132, COL. BARRIO DE SAN BARTOLOMÉ,  
C.P. 90970, SAN PABLO DEL MONTE, TLAX.  
TEL.: 222 271 7502

**VERACRUZ** **LA CASA DISTRIBUIDORA TRUPER**  
BLVD. PRIMAVERA, ESQ. HORTENSIA S/N, COL.  
PRIMAVERA C.P. 93308, POZA RICA, VER.  
TEL.: 782 823 8100 / 826 8484

**YUCATÁN** **SUCURSAL MÉRIDA**  
CALLE 33 #600 Y 602, LOCALIDAD ITZINCAB Y MULSAV,  
MPIO. UMAN, C.P. 97390, MÉRIDA, YUC.  
TEL.: 999 912 2451



Code	Model	Brand
102417	CPB-180	 <b>TRUPER®</b>

Warranty. Duration: 1 year. Coverage: parts, components and workmanship against manufacturing or operating defects, except if used under conditions other than normal; when it was not operated in accordance with the instructive; was altered or repaired by personnel not authorized by  **TRUPER®**. To make the warranty valid, present the product, stamped policy or invoice or receipt or voucher, in the establishment where you bought it or in Corregidora 22, Centro, Cuauhtémoc, CDMX, 06060, where you can also purchase parts, components, consumables and accessories. It includes the costs of transportation of the product that derive from its fulfillment of its service network. Phone number 800-018-7873. Made in China. Imported by Truper, S.A. de C.V. Parque Industrial 1, Parque Industrial Jilotepec, Jilotepec, Edo. de Méx. C.P. 54257, Phone number 761 782 9100.



1  
YEAR

Stamp of the business. Delivery date: